

Huawei E220 USB Modem – Setup Guide

- 1) Plug in the Huawei E220 into an available USB port on your Laptop or PC.

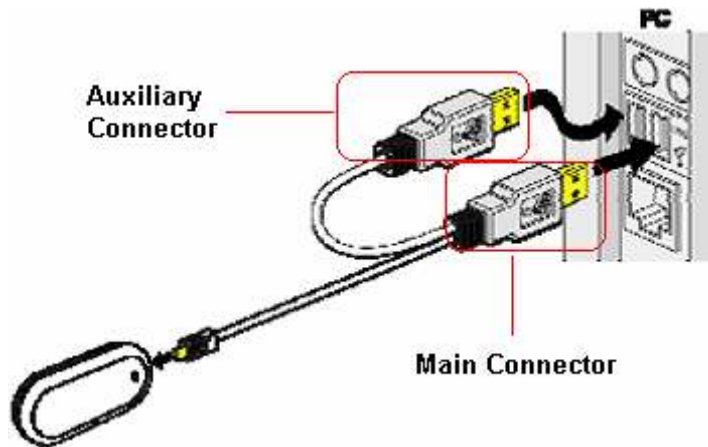

Note: The "Main Connector" must always be plugged in, however if when the modem is plugged in there are no lights flashing, the second Auxiliary Connector must also be plugged in for correct operation (Modem requires at least 5V from the USB connector for successful operation).

- 2) A series of "Windows Found New Device" pop-ups will be displayed as below to install the required driver software for modem operation.

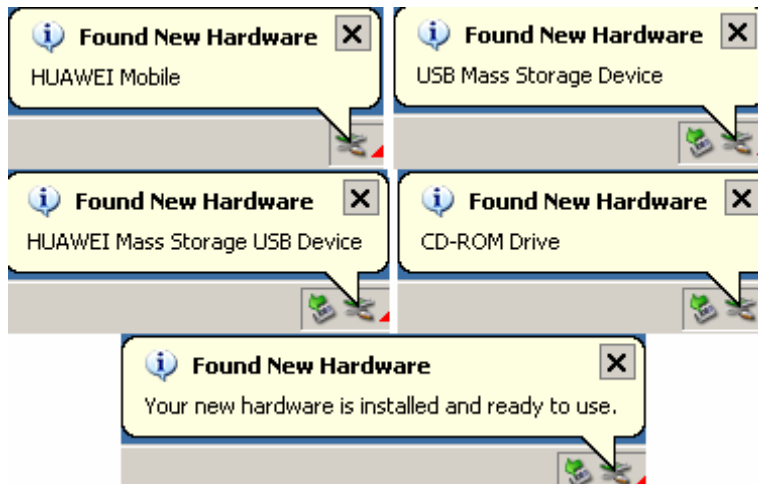

Please wait until "Your new hardware is installed and ready to use" is displayed.

3)	<p>The modem drivers will now be installed. Windows should automatically launch the driver loader. However, if it doesn't, manually launch the driver loader by:</p> <ul style="list-style-type: none"> • Double click on My Computer on the desktop. • "Mobile_Connect" should be displayed as a mass storage device. • Double click on "AutoRun.exe".
4)	<p>Once the installation screen loads,</p> <ul style="list-style-type: none"> • At the Welcome screen, select Next • License Agreement must be read and understood before selecting the Accept option followed by Next. • At the Destination Screen, either leave as default or hit Change to choose another location, followed by Next. • Choose the name of the folder to be called in your Start up menu (or leave as default, which is recommended) followed by Next. • The installation program will then progress through installing the required 3G Wireless Broadband software. • The installation program will then complete, select Finish to finalise. <p>Note: Please do not launch the wireless application at this point. You will need to wait until step 5 occurs. Please leave the modem plugged in.</p>
5)	<p>Once the installation completes a series of ten or so Windows Popup screens will be displayed, you must not launch the wireless application till these popup screens finish. Once you see the "Your new hardware is installed and ready to use" the device will be ready for use.</p>
6)	<p>You will then notice a "Wireless Connect" icon on your desktop and start menu.</p> <p>To log onto the Internet, double click on the "Wireless Connect" icon on the desktop and click on Connect.</p>
7)	<p>The installation procedure is now complete.</p>